

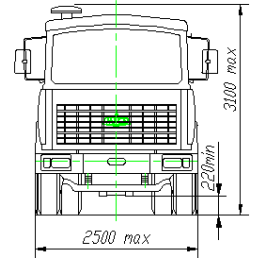

Truck concrete mixer Belarus MAZ-551605-247-750

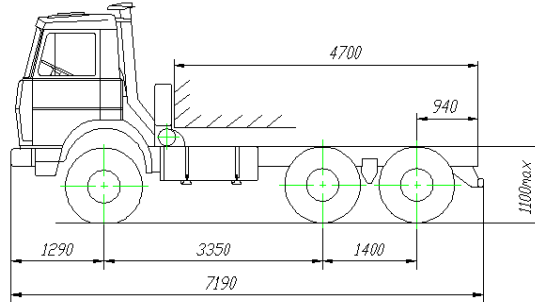

PURPOSE:

Installation of special equipment and traffic on the roads with allowed axial load on double axes (carriage) to 26 tp.

LOAD PARAMETERS:	
Payload carried, kg	23300
Mass of the equipped automobile, kg	9625
Gross mass of the automobile, kg	33000
Load on a road by the automobile by gross mass, kg:	7000
- through tires of front axle	26000
- through tires of rear carriage	25
Max rise overcome by the automobile by gross mass, % not less	
ENGINE:	
Model	YAMZ-238DE2T (Euro-2)
Diesel, 8 cylinder, V-type, with turbo-supercharging and intercooler.	
Displacement, l	14,86
Power, kW (hp).	
- at frequency of rotation, min ⁻¹	244 (330)
Max torque, N·m	2100
- at frequency of rotation, min ⁻¹	1274
Cooling system:	1100-1300
liquid, closed type with forced circulation of cooling liquid, extension tank and coupling of fan disconnecting.	
- capacity, l	47
Lubrication system:	
mixed with the water-to-oil cooler, filter with the paper element and filter of centrifugal clearing.	
- capacity, l	
Fuel system:	
In-line, fuel injection pump, filters of primary and secondary clearing.	32
Fuel tank, l	350

Head Office: 3-1136 Centre St, Ste. 124, Thornhill, ON, L4J 3M8, Canada

Warehouse: 2682 Highway 34, Hawkesbury, Ontario, K6A 2R2, Canada

Tel: 1-855-2GO-4MTZ (1-855-246-4689) **Fax:** 1-647-933-9066 **E-mail:** info@mtzequipment.com **Web:** www.mtzequipment.com

CLUTCH: Friction, dry, single disk. The hydraulic drive with pneumatic booster.	MFZ-430
GEARBOX: Mechanical, non synchronisers, with dual high transmission. Quantity of transfers is 9.	9JS135A
DRIVING AXLE: Middle and rear, two-stage with the central reducer and wheel cylindrical transmissions of planetary type. It has a lock of interwheel and interaxle differentials. Maximum speed of automobile, km/h	u₀= 6,4 85
FRONT AXEL: Controlled type, beam of I-section axis with rotary cams fixed on needle bearings.	
FRAME: Type "longeron in longeron". From stamped parts. In front part there is towing fork and two hooks, in rear part there is bumper of safety.	
FRONT SUSPENSION: Dependent, on longitudinal semielliptical springs, with two hydraulic double-side operation shock absorbers of telescopic type and stabilizer of cross-sectional stability.	
REAR SUSPENSION: Walking-beam type with six torque rods and cross-sectional stability device.	
WHEELS: Disk, fasten by 10 nuts. Quantity: Spare wheel:	8,5-20 10 1
TYRES: Pneumatic, with universal figure of the protector. Dimensionality: Index of payload capacity: Index of speed:	12.00R20 154/149 J
STEERING GEAR: With the hydraulic booster. The control column is regulated on altitude, angle of declination, is supplied with anti-thief and trauma protection devices.	
BRAKE SYSTEM: Pneumatic, with the separate drive of front and rear wheels.	
WORKING: Working brake is foot type, brake mechanism is drum type. ABS.	
PARKING: Influences on rear wheels from spring power accumulators having the pneumatic drive.	
AUXILIARY: Throttling type, has a throttle plate installed in the engine exhaust pipeline and controlled by air cylinder.	
ELECTRIC EQUIPMENT SYSTEM: Single-wire, direct current with nominal voltage 24V. The negative pole energy of the accumulator battery is connected to the frame. There are 2 batteries by capacity of 190 Amp-hrs. Generator: 28V, 80A. Starter: 24V, 5,5kW.	
CAB:	

Head Office: 3-1136 Centre St, Ste. 124, Thornhill, ON, L4J 3M8, Canada

Warehouse: 2682 Highway 34, Hawkesbury, Ontario, K6A 2R2, Canada

Tel: 1-855-2GO-4MTZ (1-855-246-4689) **Fax:** 1-647-933-9066 **E-mail:** info@mtzequipment.com **Web:** www.mtzequipment.com

<p>All-metal, two-place, two-door, can be through front an angle of 55° . Seats on sprung suspension.</p>	
<p>WIND SCREEN: Triplex with electric windshield washer. - capacity of electric windshield washer, l</p>	10,0
<p>The installing of superstructure (for guarantee saving) is approved by manufacturer's technical departments. The manufacturer reserves the right to itself to make modifications directed on improving of the automobile parameters.</p>	

Head Office: 3-1136 Centre St, Ste. 124, Thornhill, ON, L4J 3M8, Canada

Warehouse: 2682 Highway 34, Hawkesbury, Ontario, K6A 2R2, Canada

Tel: 1-855-2GO-4MTZ (1-855-246-4689) **Fax:** 1-647-933-9066 **E-mail:** info@mtzequipment.com **Web:** www.mtzequipment.com